

# TWILIGHT

S I G N A T U R E



# TWILIGHT

---

Twilight™ Signature, a luxury ultra-lite travel trailer, was designed around customers who are mindful of weight and size, but demand sophistication and high-end amenities. After surveying consumers about how they camp, where they camp, and what features are most important, we have crafted the Twilight™ Signature. We use top grade materials like tongue & groove plywood flooring, Azdel composite fiberglass and our welded aluminum superstructure combined with proven construction methods to increase the life of our travel trailers. In addition, each Twilight™ Signature features Goodyear tires and our Rain-A-Way, barreled walkable roof. As you explore the Twilight™ series, pay close attention to the finer details we've included to make your travels comfortable and safe. At the end of the day, quality and customer satisfaction is what matters most. Because we care, 100% of our Twilight™ Signature travel trailers undergo extensive quality control measures to ensure durability and longevity. Having confidence in knowing that you have chosen the best, is the Twilight™ Signature standard.

---

S I G N A T U R E





# TWILIGHT

When touring any Twilight™ Signature interiors, pay attention to the finer details from the King Size Serta Comfort mattress inclusive with USB charging stations in the neighboring nightstands, to our solid surface kitchen countertops and dream dinette. We have even upgraded to black-out roller shades to allow for private time, when needed. Furthermore, our residential tri-fold sofa provides luxury comfort.





STANDARD PACKAGES



**TWILIGHT™ SERENITY SUITE**

- Patent Pending King Bed Slide System
- True Serta Comfort Mattress
- Dual Nightstands With 110 Power
- Black-Out Roller Shades For Ultimate Privacy
- Adjustable Reading Lights With USB Charging Ports



**SAFETY FIRST PACKAGE**

- Goodyear Tires With Aluminum Rims
- Heavy-duty Axles With Industry Leading Warranty
- Detachable Ladder Prep For Walkable Roof
- Power Tongue Jack
- Power Stabilizer Jacks



**WHOLE RV PROTECTION**

- 15000 BTU High performance A/C with Heat Pump
- Whole RV Dual Ducted A/C System
- Insulated Holding Tanks With Forced Heat Protection
- Triple Seal Slide System Technology
- Rain-A-Way Radius Roof Construction



**CHEF TECH KITCHEN**

- Solid Surface Kitchen Countertops
- 10 cu.ft. Stainless Steel Refrigerator
- Gourmet Recessed Oven
- Upgraded Microwave Oven
- High Output Range Hood
- Residential High Rise Faucet With Pull Out Sprayer



**TWILIGHT™ ELITE COMFORT**

- Dream Dinette Tech System
- Residential Tri-Fold Sofa
- Porcelain Toilet
- Large LED TV
- Bluetooth Stereo System

When designing the Twilight™ Signature, the goal was to provide exceptional quality and consumer friendly features. We started with a tire name you can trust, Goodyear. We then created the Whole RV Comfort package, which provides extended season capabilities with an insulated and enclosed underbelly, with forced heat to the holding tanks. The Twilight™ Signature series comes standard with a 15,000 BTU A/C, and is the industry's first ultra-lite travel trailer with a built in heat pump featuring a digital thermostat. We round out this RV with a dual ducted A/C system engineered for quicker cooling during the summer heat.

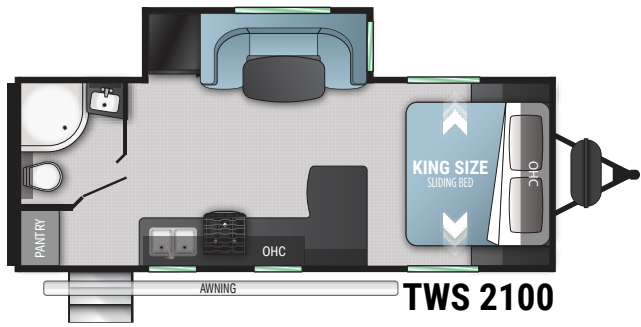

**TWS 2100**

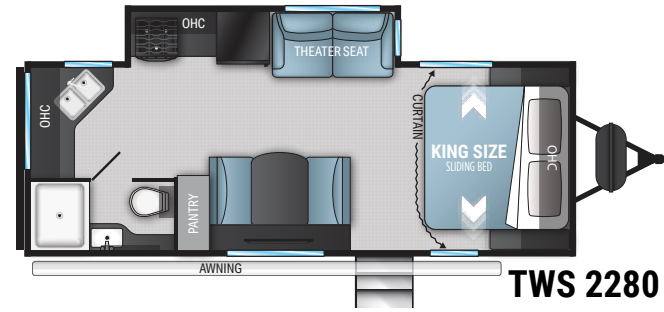

**TWS 2280**

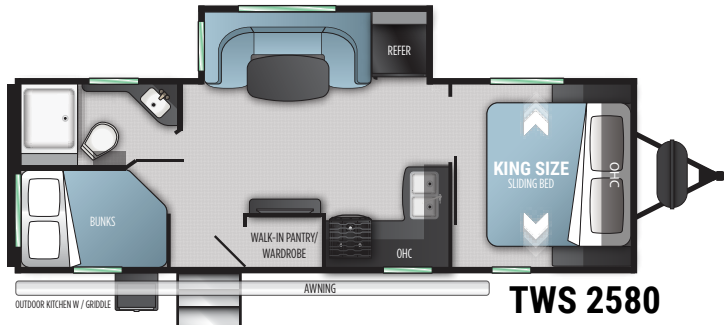

**TWS 2580**

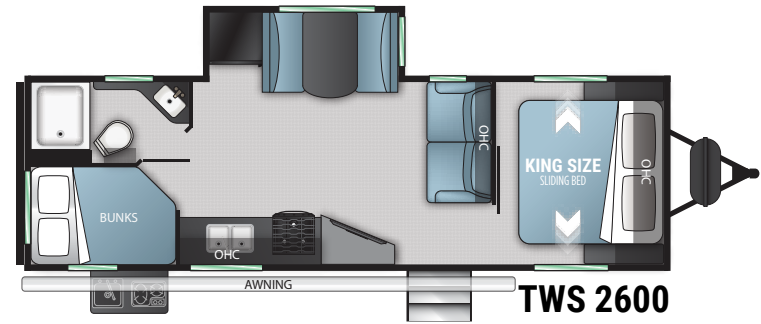

**TWS 2600**

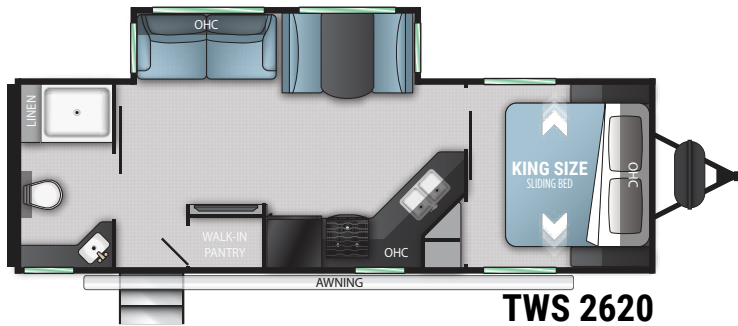

**TWS 2620**

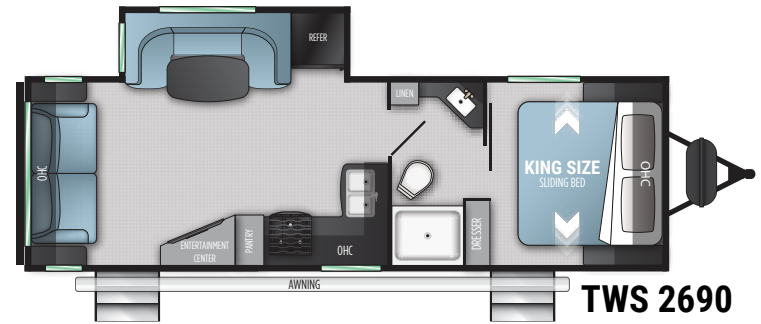

**TWS 2690**

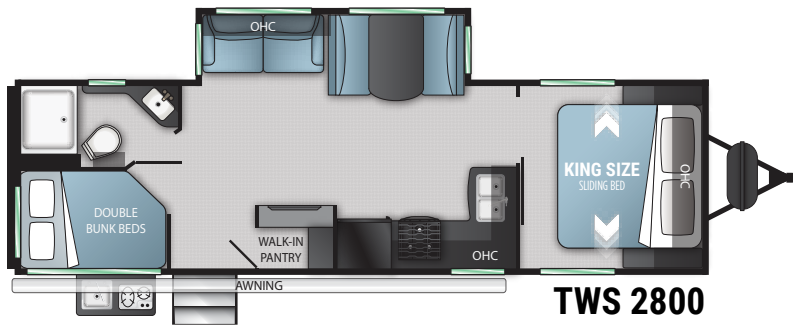

**TWS 2800**

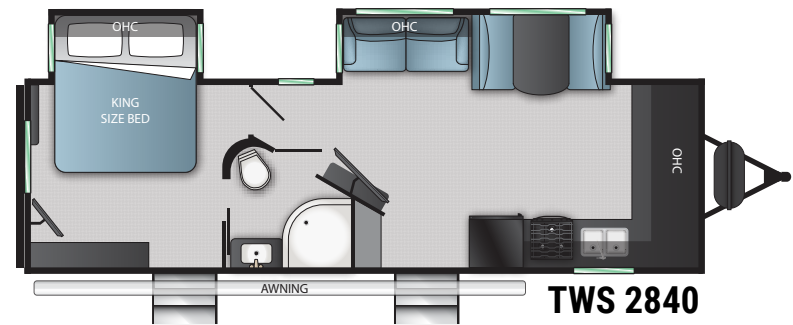

**TWS 2840**

## STANDARDS AND OPTIONS

### Interior:

- 72 x 80 King Bed Slide System
- Serta Comfort Mattress w/ Upgraded Bedding
- Seamless Countertop Nightstands
- Solid Surface Kitchen Countertop
- Deep Bowl Stainless Steel Kitchen Sink
- High-Rise Kitchen Faucet w/ Pull-out Sprayer
- Upgraded Appliance Package w/ Recessed Glass Cover Cooktop/Oven
- 10 cu.ft. Stainless Steel Refrigerator
- Hardwood Cabinet Doors
- Concealed Cabinet Door Hinges & Metal Full-Extension Drawer Guides
- Dream Dinette w/ Wall Bracket & One-piece Table
- Hidden Dinette Seat Storage
- Residential Tri-Fold Sofa
- Black-out Roller Shades Throughout
- Deluxe Valance Design
- Upgraded Interior Passage Doors
- Large HD LED TV
- Bluetooth Stereo System
- Seamless Bathroom Countertops
- Porcelain Toilet
- High Grade Vinyl Flooring

### Exterior:

- Goodyear Tires
- Heavy-duty Axles
- Painted Fiberglass Front Cap w/ LED Lights
- Signature Exterior Graphic Design
- Fully Laminated Fiberglass Exterior Sidewalls
- Rain-A-Way Barreled Roof Design
- Detachable Ladder Prep for Walkable Roof
- Power Tongue Jack
- Power Stabilizer Jack System

- 30" Wide Entry Door
- Solid Step at Main Entry
- Extra Large Entry Door Grab Handle
- Keyed-A-Like Door System
- Power Awning with LED Lighting
- Exterior Speakers
- WiFi / LTE Prep
- Solar Prep
- Back-Up Camera Prep
- Black Tank Flush
- Outside TV Prep
- 40+ cu.ft. Pass Through Storage w/ Slam Latch Doors
- Dual 20lb. LP Tanks

### Construction/HVAC

- Structural I-Beam Frame w/ Full Height Cross Members
- Whole Home Protection System
- 16" On Center Floor Joists
- 5/8" Tongue & Groove Plywood Flooring
- Plywood Slide-Out Floors
- Triple-Seal Slide System Technology
- Welded Aluminum Superstructure
- Walkable Roof w/ 16" On Center Rafters
- Dual Ducted A/C System
- 15,000 BTU Main A/C
- Heat Pump w/ Digital Control
- Tinted UV Protected Windows
- 30,000 BTU Furnace w/ Forced Tank Heating

### Options:

- 50 amp service
- 2nd 13,500 BTU Ducted A/C (some models)
- Bumper Mounted Grill
- 8 cu.ft. Gas/Electric Refrigerator
- Theater Seat (some models)
- Theater Dinette (some models)

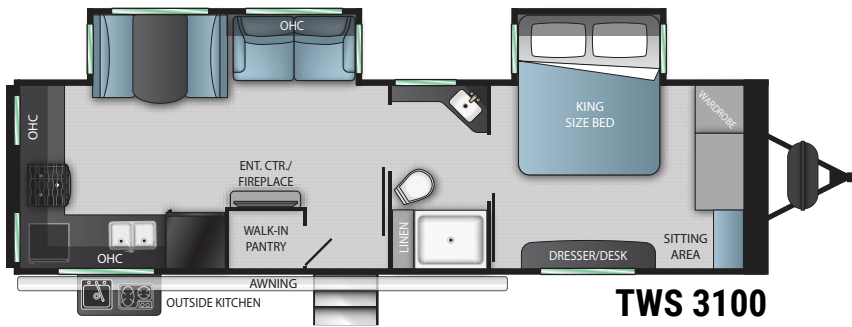

**TWS 3100**

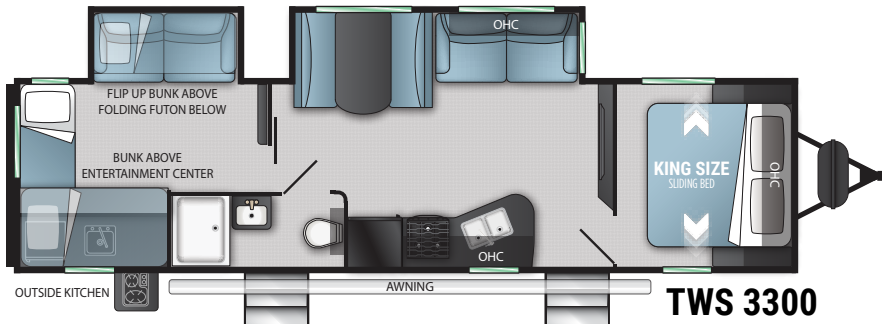

**TWS 3300**

MODEL	LENGTH	DRY	HITCH	HEIGHT	TANKS
2100	25' 10"	5,322	420	10' 11"	44 <sup>F</sup> 30 <sup>G</sup> 30 <sup>B</sup>
2280	26' 11"	5,370	564	10' 11"	44 <sup>F</sup> 30 <sup>G</sup> 30 <sup>B</sup>
2580	29' 9"	5,956	784	11' 2"	44 <sup>F</sup> 87 <sup>G</sup> 30 <sup>B</sup>
2600	30' 11"	6,196	955	10' 11"	44 <sup>F</sup> 60 <sup>G</sup> 30 <sup>B</sup>
2620	30' 10"	6,270	790	10' 11"	44 <sup>F</sup> 60 <sup>G</sup> 30 <sup>B</sup>
2690	30' 11"	5,974	758	10' 11"	44 <sup>F</sup> 30 <sup>G</sup> 30 <sup>B</sup>
2800	32' 10"	6,546	640	11' 2"	44 <sup>F</sup> 87 <sup>G</sup> 30 <sup>B</sup>
2840	32' 4"	7,054	1,142	11' 2"	44 <sup>F</sup> 87 <sup>G</sup> 30 <sup>B</sup>
3100	35' 5"	7,464	634	11' 2"	44 <sup>F</sup> 87 <sup>G</sup> 30 <sup>B</sup>
3300	36' 6"	7,592	1,140	11' 2"	44 <sup>F</sup> 30 <sup>G</sup> 57 <sup>B</sup>



## Dedication to Quality Assurance and Continuous Improvement

Every Twilight™ Signature Series travel trailer goes through an initial quality inspection during each manufacturing phase. After completion of the trailer, it is delivered to our dedicated Pre-Delivery Inspection (PDI) Center, where it is meticulously taken through a detailed checklist. First, each unit is placed into a rain bay to ensure all window seals are airtight and there are no water leaks. After the rain bay tests, our certified technicians check every chassis, slide out, seal, gas, water, and electrical systems, appliances, and all interior and exterior elements. Once this process is completed, we clean each unit from top to bottom, inside and out to make sure we are delivering the best product to our dealers and customers.



For more information about our quality and construction story, visit us online.

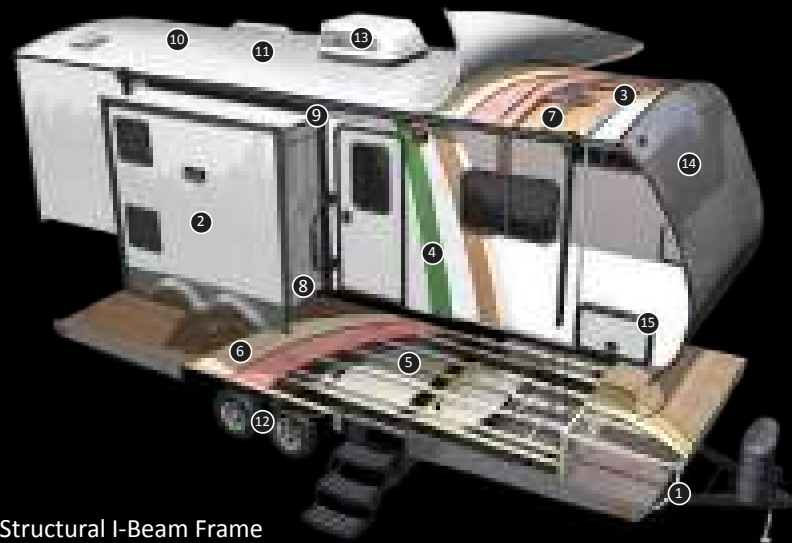

1. Structural I-Beam Frame
2. Rack & Pinion Slide-Outs
3. Aluminum Superstructure
4. Azdel Laminated Walls
5. 16" On Center Floor Joists
6. 5/8" Tongue & Groove Plywood Flooring
7. 16" On Center Aluminum Roof Rafters
8. Plywood Slide Floors
9. Triple Seal Slide System Technology
10. Walkable Roof with Rain-A-Way Technology
11. TPO Roofing
12. Goodyear Tires
13. 15,000 BTU Main A/C with Heat Pump
14. Molded Fiberglass Cap with Paint and Clear Coat
15. Oversized Slam Latch Baggage Doors



Your Authorized Twilight™ Dealer:

# TWILIGHT SIGNATURE

[www.TWILIGHTRVS.com](http://www.TWILIGHTRVS.com)

Product information is as accurate as possible as of the date of publication of this brochure. Due to Cruiser RV's commitment to continuous product improvement, floorplans, materials, components, features, measurements, specifications, options, etc. are subject to change at any time without notice or obligation. In certain conditions some additional equipment may be needed. Photos may show optional equipment or props used for photography purposes only.

Cruiser RV has listed the approximate base weight of the trailer without the optional equipment included. Optional equipment will impact the weight of the trailer. Please locate the weight sticker attached to the trailer you are considering for the most accurate trailer weight.

**Tow Vehicle Caution:** Owners of Cruiser recreational vehicles are solely responsible for the selection and proper use of tow vehicles. All customers should consult with the motor vehicle manufacturer or their dealer concerning the purchase and use of suitable tow vehicles for Cruiser RV products. Cruiser RV disclaims any liability or damages suffered as a result of the selection, operation, use or misuse of a tow vehicle. Cruiser RV's limited warranty does not cover damage to the recreational vehicle or the tow vehicle as a result of the selection of the tow vehicle.