

373 WEIGHT 16325 LENGTH 39' 6"

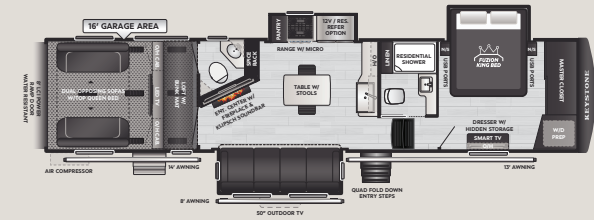

419 WEIGHT 16935 LENGTH 44' 6"

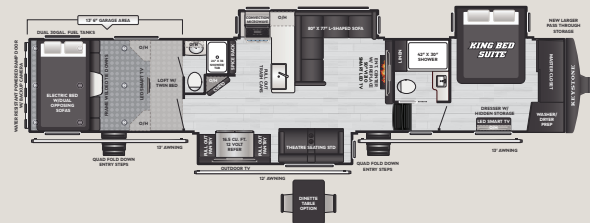

432 WEIGHT 17615 LENGTH 46' 1"



440 WEIGHT 17110 LENGTH 45' 11"

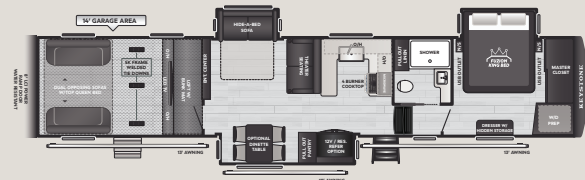

442 WEIGHT 17025 LENGTH 46' 8"



STANDARD FEATURES & OPTIONS

INTERIOR

- ◆ Interior Design Refresh
- ◆ **NEW** Island Design
- ◆ **NEW** Cabinet Construction
- ◆ Pull-Out Pantry (**SELECT FLOORPLANS**)
- ◆ Solid Surface Countertops
- ◆ Upgraded 20 cu. ft. 12V Refrigerator
- ◆ 4-Burner Residential Range & Oven
- ◆ 30" Convection Microwave
- ◆ Farmhouse Style Stainless Steel Kitchen Sink w/ Roll-Up Sink Cover
- ◆ JBL® Living Room Sound Bar
- ◆ 7' Living Area Slide Box Height
- ◆ 5" Dimmable Flush Mount Lighting
- ◆ 70x80" King Bed on Slide
- ◆ **NEW** Bathroom Design
- ◆ **NEW** Larger Fiberglass Shower w/Upgraded Shower Head Unit
- ◆ Pull-Out Linen Storage
- ◆ Larger Vanity Countertops
- ◆ Adjust-A-Track™ Frame-Welded Tie Down System w/ 38 Points of Contact
- ◆ Integrated Dove Tail Storage Box
- ◆ Furrion Toy Camera in Garage
- ◆ Furrion Chill® Cube A/C's

EXTERIOR

- ◆ Electric Through Frame Flush Floor Slides
- ◆ **NEW** Painted Fiberglass Cap w/ Patented KeyShield™ Protection w/Integrated LED Lighting
- ◆ Fortified Chassis w/ Best in Class Pass Through Storage (105 cu.ft)
- ◆ Best In Class Tank Capacity (173 Gallon Fresh, 104 Gray/ Black Tanks)
- ◆ Additional Battery Top-Down Access Door in Pass-Through Storage
- ◆ Curt Helux™ Pin Box
- ◆ Best In Class Standard 8K LBS. Dexter® Axles
- ◆ 17.5" Rims With H-Rated Tires
- ◆ Dexter EZ-Flex® Suspension
- ◆ Improved GVWR Rating
- ◆ Convenience Center w/Electric Dump Valves
- ◆ Keystone Exclusive Power Ramp Door
- ◆ Ramp Door Patio Package w/Side Entry Steps
- ◆ 3 Seasons Sliding Rear Patio Doors
- ◆ RV Mobile Power™ Flex Power® 5500e Generator w/ Dual Fuel Gasoline and LP Capabilities
- ◆ Lippert Titan 6PT Hydraulic Leveling System
- ◆ Main Entry Collapsible Solid Steps
- ◆ MORryde Safe-T-Rail Collapsible Grab Handle
- ◆ 4k Square Windows with Integrated Blinds
- ◆ 50-AMP Power Cord Reel
- ◆ Integrated Air Compressor
- ◆ Furrion Backup Camera

- ◆ Banded TPMS System
- ◆ Girard Cassette Awnings
- ◆ **NEW** Skirt Metal & Fenders
- ◆ Upgraded Outdoor Entertainment Area w/ 50" Smart TV
- ◆ JBL® Bluetooth Party Box
- ◆ Dual 30-Gallon Integrated Fuel Cells

OPTIONS

- ◆ **NEW** Full Body Paint Options Available: Frost White, Galaxy, Desert Metallic, Black Metallic (Available in Gloss & Matte Finish)